

P R I N C E S S
BANDAZUL

MAX SPEED
20 KNOTS

CABINS
4

YEAR
2018

LOCATION
SPAIN

LENGTH
30.45M



P R I N C E S S
BANDAZUL

INTRODUCTION

Bristow-Holmes are delighted to offer the stunning Princess 30M M/Y BANDAZUL for sale. Delivered to her owner in Spring 2018, this is a unique opportunity to beat the waiting list and own this 2019 World Super Yacht Award nominee.

The result of a close collaboration between its owners and the in-house Princess Design Studio, this Princess 30 Metre is unlike any other. The stylish interior is a testament to the owner's dedication and eye for detail, as well as Princess' desire to build an outstanding British yacht for an experienced North European owner.

This custom 30 Metre Princess is unique. The Owners brief requested the ultimate blend of relaxed living and style, offering maximum interior volume and practicality. The Saloon has been completely reinvented by removing the dining table (easily installed if required) and thus opening up the extended informal seating and relaxation areas that reach all the way forward to the galley bulkhead.

BANDAZUL boasts a dark shade of Wenge timber (a custom request) which contrasts beautifully with the free-standing furniture, sourced from Minotti in Italy. Fixtures and fittings were upgraded throughout, with contemporary finishes fitted to various furniture and units throughout. Even the Galley flooring is in-keeping with the Italian look specified by the Owners and features a stone tiled floor. Only the highest quality Italian soft furnishings and loose furniture were selected, something that you notice the moment you step onboard this stunning motor yacht.





SPECIFICATION

Builder	Princess Yachts
Model	30 Metre Yacht
Location	Spain
Engines	2 x MTU 12V 2000 M96L
Year	2018
Exterior Designer	Princess Yachts
Length	30.45 Metres / 99' 11"
Beam	7.05 Metres / 23' 1"
Draft	2.08 Metres / 6' 9"
Guests	8
Cabins	4
Cabin Configuration	1 Master - 1 VIP - 1 Twin - 1Twin/Double
Crew Accomodation	5
Crew Cabins	1 Captain Cabin - 2 Twin Crew Cabins
Hull	Resin Infused Composite
Classification Yachts -	RINA Rules for Pleasure
	C HULL MACH Y
UNRESTRICTED	
Max Speed	20 Knots
Cruising Speed	15 Knots



COLOURS

- Hull - White
- Hull Band - White
- Boot Top - Jet Black
- Superstructure - White
- Hardtop - White
- Coach Roof - White
- Cabinetry - Special Wenge Interior Timber
- Interior Furniture - Minotti, Kettal, Julian Chichester etc.



BANDA ZUL

The cockpit was re-designed and re-thought too; out went the fixed aft cockpit table, to create another spacious and relaxed seating area, which complements the interior spaces, attended by its own well-equipped bar unit. Meanwhile the yacht's dining area has been relocated to the Flybridge, directly below the electrically opening hard top, allowing guests to dine under the stars or in the shade if required. Notably the hard top was re-designed as well, extended aft at the request of the Owner, not only for practical reasons, but also to further enhance the yacht's side-profile.

Back inside, the Master Stateroom is located on the Main Deck, one of the Princess 30M's principal benefits. Here the Owners simplified and rationalised the space to create a more open and practical area in both the stateroom itself and the en-suite bathroom. Low-level custom seating was installed in the Master Cabin and the lower deck full beam VIP, in order to give guests that added area of privacy if required.

With two further twin guest cabins accessed from the Lower Deck Lobby (one of which features sliding beds to convert to a double cabin if required) BANDA ZUL is perfectly optimised for up to 8 guests in luxury and comfort.

For more information on this stunning Motor Yacht please do not hesitate to contact Bristow-Holmes, the world's truly boutique brokerage house.





M A S T E R C A B I N



ADDITIONAL OPTIONS



GALLEY

Galley and Servery Floor Features Large Square granite floor tiles in Porcelanosa Portland Antracita

Galley and Servery Worktops Organic White 4600 Granite i

Galley Units Special Order Grey Finish

Galley Worktops feature returns around all surfaces

Special Order

2 x Full Height Fridge Freezers



NAVIGATION UPGRADES

Upgraded Navigation System to High Specification Full Simrad Installation

6ft X-Band Radar

3ft X-Band Radar

Main Helm - 2 x 24" Displays and 2 x 12" Displays (In Addition to 15" Display for Ship's Monitoring System)

Main Helm - 1 x 15" Dedicated Alarm, Control and Monitoring System Display

Main Helm - 3 x 4.1" Colour Multi Functional Displays

Main Helm - VHF Handset (incorporating Multi-Station Loud Hailer)

Main Helm - Autopilot with Enhanced Control Interface

Main Helm - GPS Compass

Main Helm - Upgraded Magnetic Compass

Flybridge Helm - 2 x 16" Touch Screen Displays (in Addition to 10" Display for Ships Monitoring System)

Flybridge Helm - VHF Handset (incorporating Multi-Station Loud Hailer)

Flybridge Console - 2 x 4.1" Colour Multi Functional Displays

AV EQUIPMENT

KVH TV8 Tracvision Satellite TV Antenna System in 89cm Dome

Dummy 89cm Dome Fitted to Port Side

Master Stateroom, Saloon and Lower Deck Cabins Feature Universal Remote Control System. Decoder, Receiver and TV Functions Programmed to a Single Device in Each Area.

Exterior Audio System Features Upgraded Speakers, Amplification and Sonos control functionality (3 Zones - Cockpit, Foredeck and Flybridge)

Pre-Wiring for Satellite TV Decoders for Master Stateroom, Saloon and Lower Deck Guest Cabins

32" TV with MS-AV700i Radio/mp3/DVD in Galley / Crew Mess Area

55" UHD TV in Master Stateroom

55" UHD TV in VIP Cabin

3G/4G GSM Router Capable of High-Speed Bonded Bandwidth Connectivity

Multiple Wireless Access Points with Comprehensive WiFi Coverage

Onboard Wired Network, with Cabling to TVs



ENGINEERING UPGRADES

TRAC 16X Fin Stabiliser System Providing Stabilisation Underway and at Rest. Additional Electro-Hydraulic Motor Powers System for Stabilisation at Rest When Main Engines are Shutdown

Secondary TRAC Cooling Pump on Changeover Valve for Redundancy in Event of a Failure

WASP Oil Change Unit to Cover Engines, Gearboxes and Generators

Standard Bow Thruster Upgraded to 75HP

Icemakers fitted in Cockpit Bar , Servery and Flybridge Bar

ASEA Shorepower Converter (45kVa - 63 Amps Per Phase) Including Dedicated Chilled Water Cooling System.

Drawer Fridge Fitted in Flybridge Wetbar

Vimar Multi Regional Electrical Sockets (220v/240v)

Domestic and Engine Start Batteries Upgraded to Sealed Gel Type

All Interior and Exterior Lighting to be Dimmable

Up-Lighters Fitted to illuminate Mast. Consisting of Two LED Floodlights Mounted on Top-Side of Hardtop

Electric Blinds in Master Cabin, Main Saloon and Lower Deck VIP Cabin

Air Conditioning Fan Coil Units Upgraded to DC Units from Dometic for Quieter Operation

4 Underwater Lights on Transom and 2 Each Side Around Aft Area

Additional USB Chargers fitted in Master Cabin and Lower Deck Aft VIP

Additional Red Rope Lighting Fitted in Wheelhouse Seating Area for Night Navigation

Underfloor Heating in All En-suite Bathrooms

Upgraded Flybridge Helm Seats

Electrically Operated Wheelhouse Helm Seat in Lieu of Standard Perch

Additional Air Conditioning Cooling for Under Helm Area to Safeguard Upgraded Navigation Equipment



DECK EQUIPMENT

Hull Faired and Painted in Awlgrip Awlcraft 2000 Finish

Flybridge GRP Hardtop with Electrically Operated Opening Centre Section in White Fabric

Hardtop Customised, Extended in length and Featuring Integrated Electric Extending Awning

Twin Stainless Steel Anchors

Foredeck Seating Featuring Removal GRP Infill and Cushion to Create Sunpad

Additional Deck Wash Outlet on Flybridge in Addition to Standard Bow Outlet

Custom Teak and Stainless Steel Ensign Staff

Foredeck Wind Vented Sun Umbrella with Twin Deck Sockets

3rd Station Helm Position at Starboard Side of Cockpit



INTERIOR SPECIFICATION

Bathroom Stone Upgraded to be Bianco Gioia on floors, worktops and bulkheads.

Special Wenge Interior Timber with High-Gloss Finish

Bespoke Saloon Ceiling Design featuring Wenge High-Gloss Timber Perimeter

Saloon, Main Deck Lobby, Master Stateroom, Wheelhouse Stairs and Wheelhouse features Wenge Wide Planked Timber Flooring with Single Carpet/rug overlaid in Saloon and Carpet Around Master Stateroom Bed

Interior Doors Featuring Wenge Gloss Inserts

Saloon Starboard-Side Sliding Patio Doors

Starboard Forward Stateroom (Lower Deck) Features Two Single Beds with Electrically Powered Sliding Mechanism to Convert to Double Bed

Cockpit Layout Custom In-Built U-Shaped Seating with Storage.

Master Stateroom Full Custom Arrangement

Safe in Master Stateroom Wardrobe

Flybridge Custom Arrangement Featuring L-Shaped Forward Seating and U-Shaped Aft Seating

Flybridge Freestanding Feature Dining Table and Seating

VIP Guest Cabin Full Beam Arrangement with Custom L-Shaped Sofa

Master Stateroom and VIP Cabin Beds Extended to 2.1 Metres in Length

Custom Silk Rug Fitted in Saloon

Custom Saloon Layout with Large Low Level Sofas and Integrated Side Tables

Julian Chichester Feature Sideboard Unit at Forward End of Saloon

Galley and Servery Floor Features Large Square Stone Tiles

Galley and Servery Worktops in Organic White Stone Finish

Galley Units in Custom Grey Lacquered Finish

CREW MESS

1x En-Suite Captains Cabin

2x Twin En-Suite Cabins

32" LED TV with MS-AV700i radio/mp3/DVD fitted in crew mess area



SIDE PROFILE



THE LAST NAME IN **YACHTING**

UPPER DECK

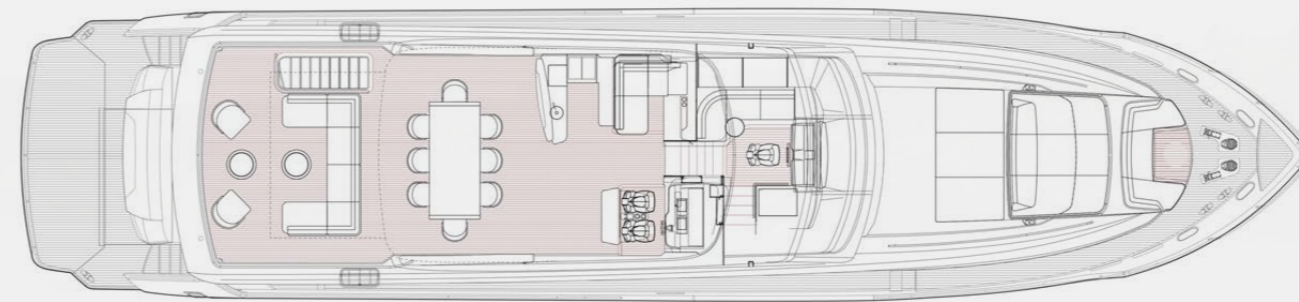

MAIN DECK

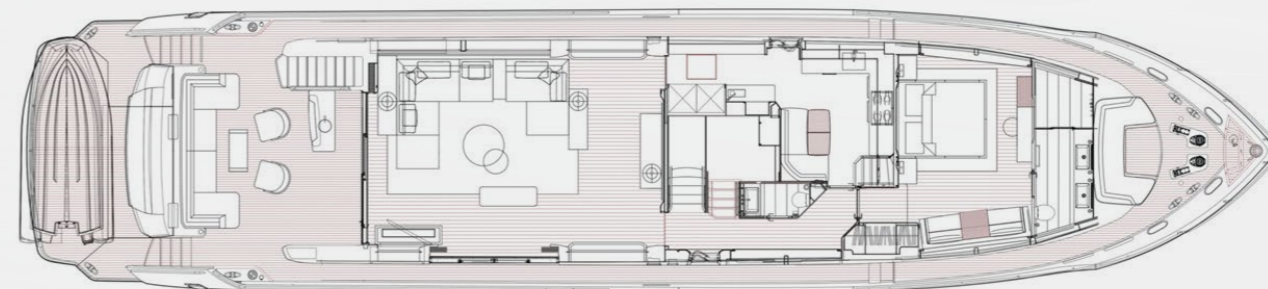

LOWER DECK



PRINCESS
BANDAZUL

BANDAZUL



**BRISTOW
HOLMES**

harry@bristow-holmes.com
Tel. +44 7881 29 74 75
www.bristow-holmes.com

[London - Dubai - Miami - Monaco - Palma - Singapore - Sydney](#)